



INSTRUCTION BULLETIN

No. 9018723
Machine: 6100E
Published: 04-2019
Rev. 00

NOTE: DO NOT DISCARD the Parts List from the Instruction Bulletin. Place the Parts List in the appropriate place in the machine manual for future reference. Retaining the Parts List will make it easier to reorder individual parts and will save the cost of ordering an entire kit.

NOTE: Numbers in parenthesis () are reference numbers for parts listed in Bill of Materials.

Installation instructions for **kit number 9018722**

SYNOPSIS:

This kit contains the parts needed to install the propel repair cable on 6100E sweepers.
Please follow step-by-step instructions.

SPECIAL TOOLS / CONSIDERATIONS: NONE

(Estimated time to complete: 1 hour)

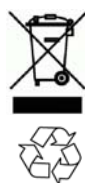

PROTECT THE ENVIRONMENT

Please dispose of packaging materials, used machine components such as batteries and fluids in an environmentally safe way according to local waste disposal regulations.

Always remember to recycle.

PREPARATION:

FOR SAFETY: Before leaving or servicing machine, stop on level surface, turn off machine, and remove key.

1. Disconnect the battery cable from the machine.



WARNING: Always disconnect battery cables from machine before working on electrical components.

2. Remove the left shroud from the machine and set the shroud aside.

INSTALLATION:

1. Disconnect the main wire harness propel leads from the controller M1 and M2 terminals. (Fig. 2/Fig. 3/Fig. 4)
2. Cut the connectors from the main wire harness leads disconnected from the controller and use electrical tape to secure the leads back against the harness. Be sure all exposed wire is completely covered with tape.
3. Disconnect the main wire harness from the drive wheel assembly. (Fig. 2/Fig. 3/Fig. 5)
4. Cut the connectors from the main wire harness leads disconnected from the drive wheel assembly and use electrical tape to secure the leads back against the harness. Be sure all exposed wire is completely covered with tape.
5. Connect the propel repair cable (1) to the controller M1 and M2 terminals. (Fig. 2/Fig. 3/Fig. 6)

6. Route the propel repair cable (1) along the main wire harness and down to the drive wheel assembly.
7. Connect the propel repair cable (1) to the drive wheel assembly. (Fig. 2/Fig. 3/Fig. 6)
8. Use the cable ties (2) to secure the propel repair cable (1) to the main wire harness.
9. If there is a cable clamp installed in the location on the drive wheel adapter plate shown in Fig. 1, remove and discard the cable clamp. (Fig. 1)
10. Remove the cable clamp securing the main wire harness to the extension spring connected to the spring to the machine. Set mounting hardware aside. Discard the cable clamp (Fig. 1)
11. Use the cable clamp (3) to secure propel repair cable (1) and main wire harness to the extension spring attached to the frame of the machine. (Fig. 1/Fig. 2)
12. Reinstall the left shroud onto the machine.
13. Reconnect the battery cable to the machine.
14. Start and test the machine. Operate the machine in forward and reverse. Ensure the propel repair cable (1) is completely secured to the main wire harness and cannot become caught in any moving parts.

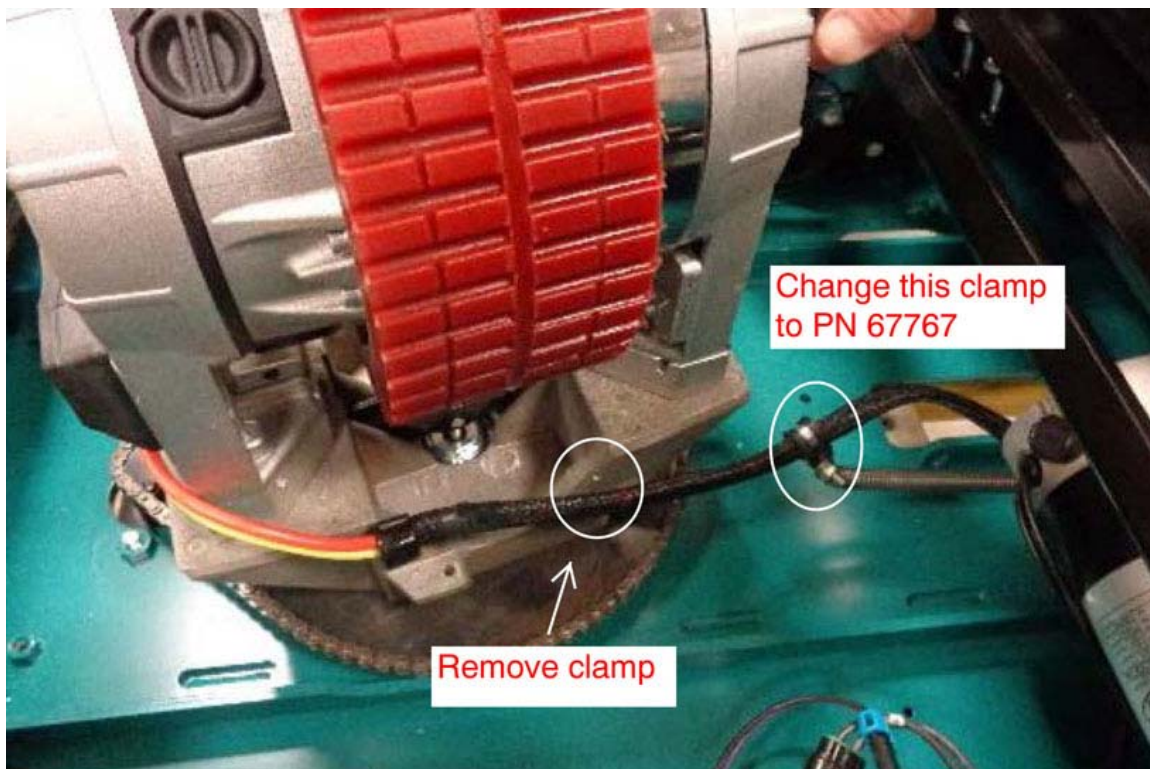

FIG. 1

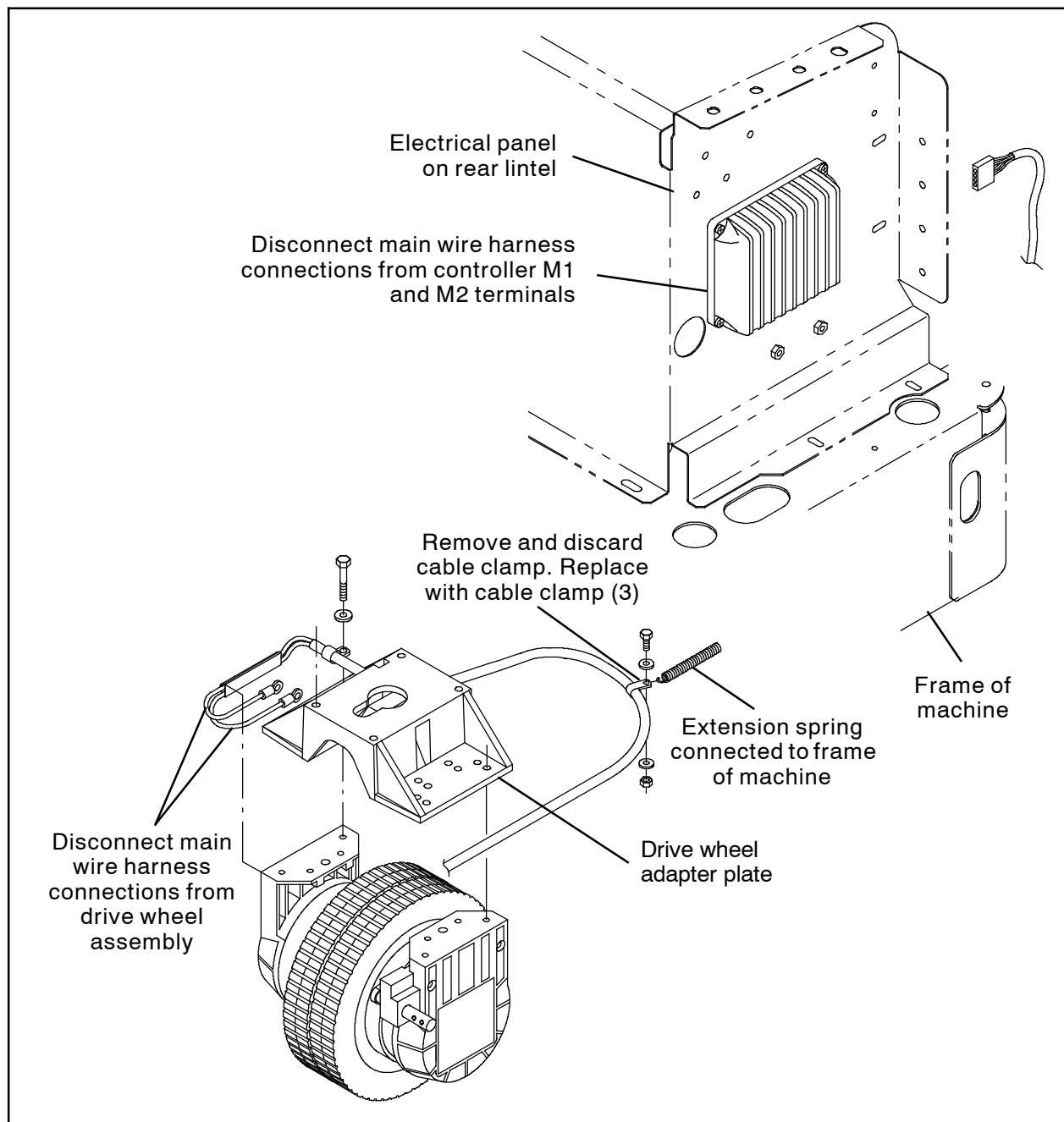

FIG. 2

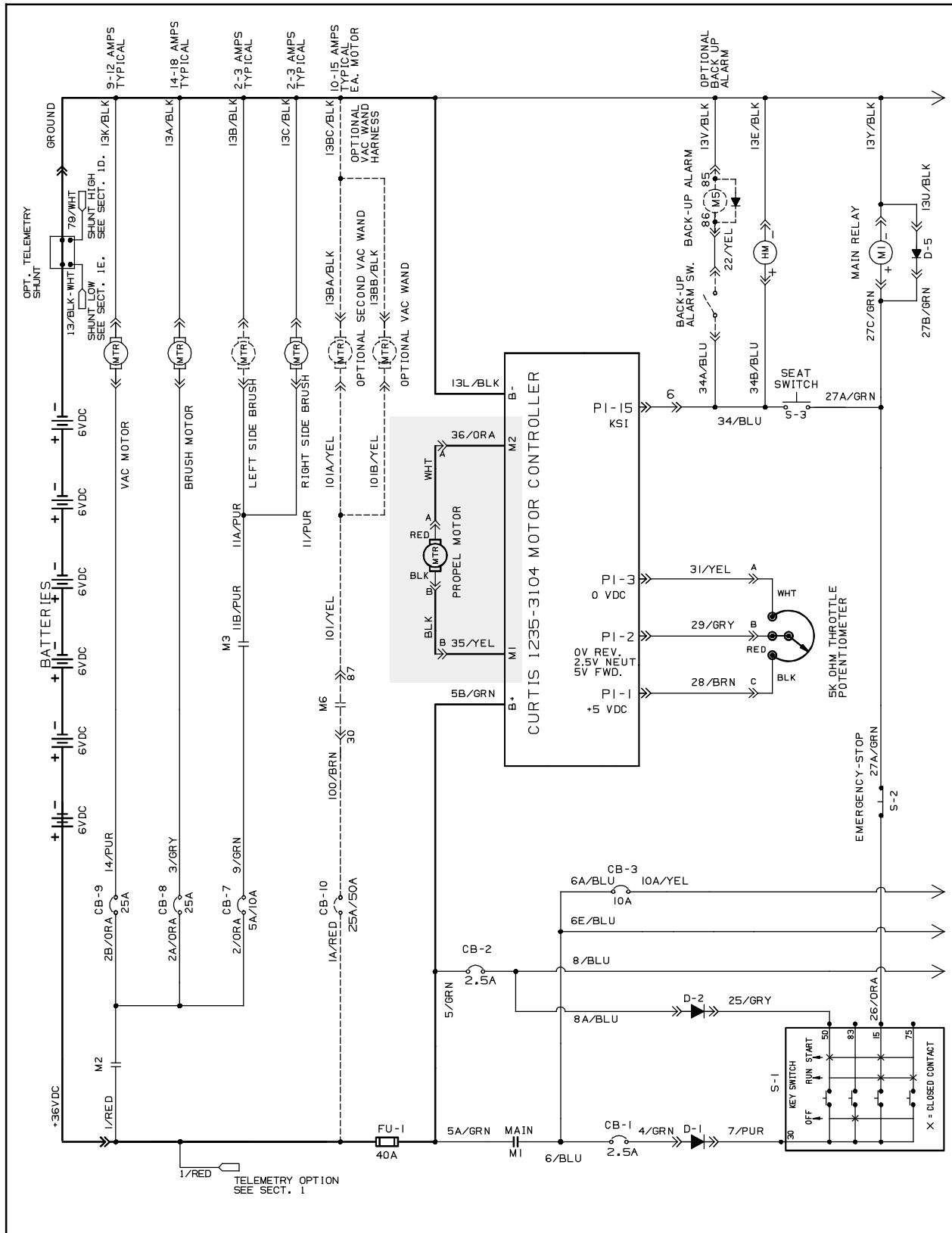

FIG. 3

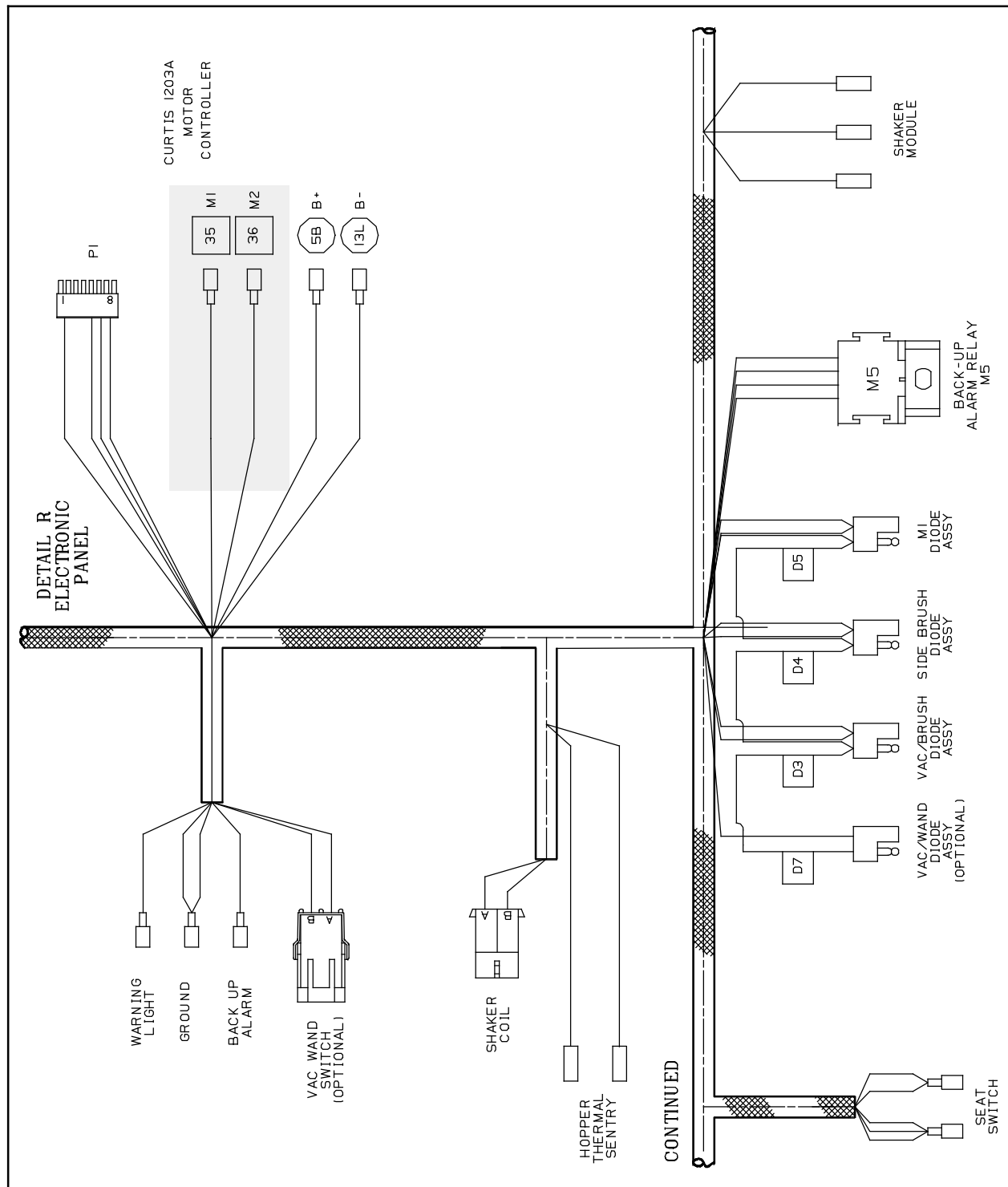

FIG. 4

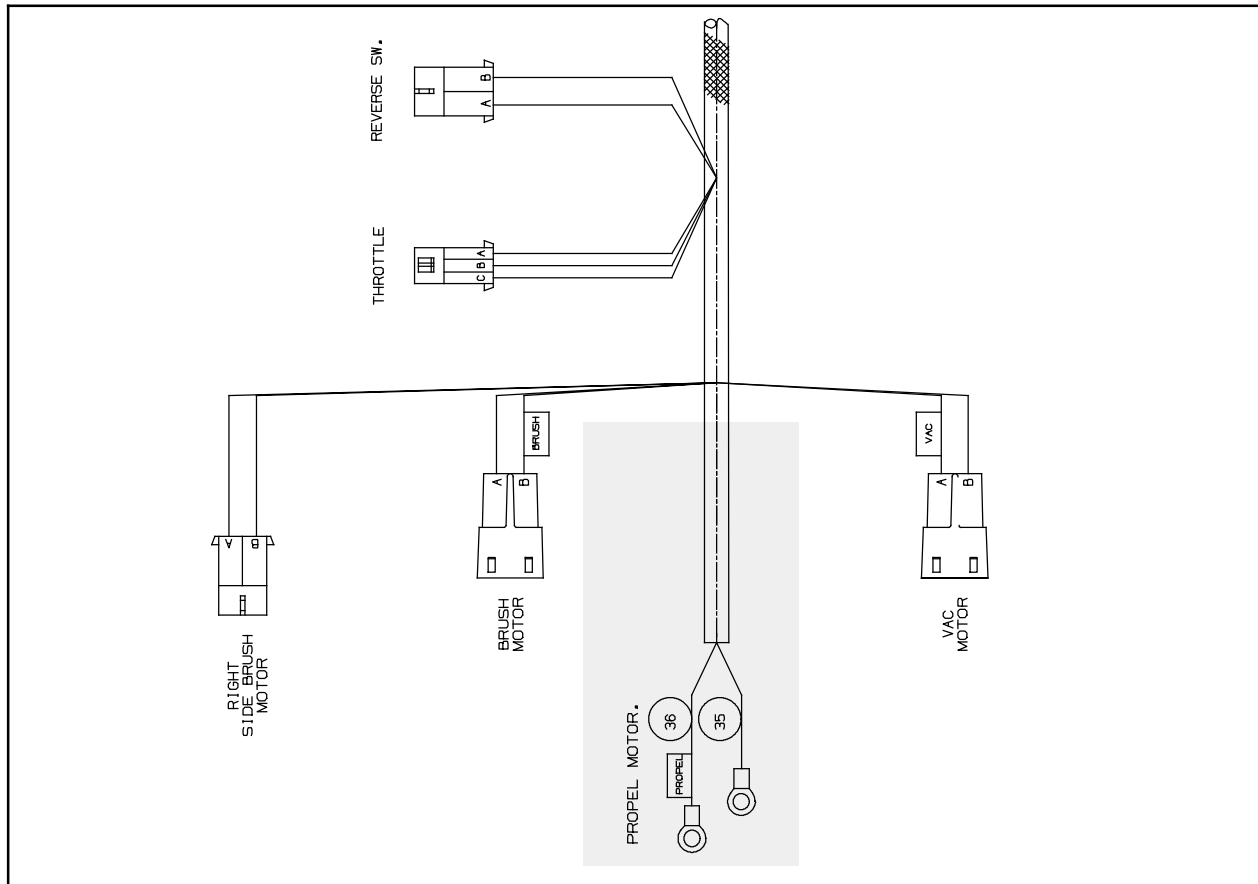

FIG. 5

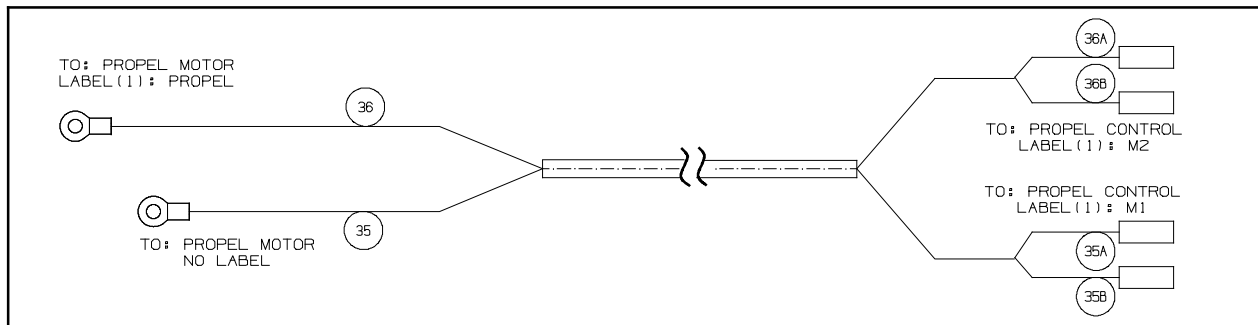

FIG. 6

Bill Of Materials For Propel Cable, Repair, Afmkt [6100] - 9018722

Ref.	Tennant Part No.	Description	Qty.
1	1076611	Cable, Ele [6100, Propel, 8GA, Repair]	1
2	49266	Tie, Cable, Nyl, 07.3L .19W 1.8 Max D	12
3	67767	Clamp, Cable, Stl, 0.69D X 0.62W, 1Hole	1

TENNANT COMPANY
P. O. Box 1452
Minneapolis, MN 55440-1452